



# INSTALLATION INSTRUCTIONS

## WiFi Gateway

### Package Contents

- WiFi Gateway
- 1 x RJ12 cable
- 5V Power Supply
- Instructions

The Gallagher WiFi Gateway is compatible with all iSeries Energizers and provides the ability to manage your iSeries Energizer via the Gallagher Ag Devices app.



### Installing your WiFi Gateway

Before installing your WiFi Gateway you need to ensure you are able to provide WiFi network coverage at the install location of your iSeries Energizer. If you are in a remote location consider a cellular mobile hotspot as a connectivity solution.

#### To install your WiFi Gateway:

1. Turn off your Energizer.
2. Connect the RJ12 cable between the Wifi Gateway and the Energizer.

If you want to use the Energizer controller, this can also be connected directly to the Wifi Gateway.

3. Connect the supplied 5V power supply to the 110V/230V supply.

#### Note:

If powering from a 12V battery please contact a Gallagher representative for assistance.





# DEVICE SETUP INSTRUCTIONS

## WiFi Gateway

### Gallagher Ag Devices App

Control and view the performance of your iSeries Energizer. Receive notifications direct to your smartphone.

### Connecting your App to your Energizer

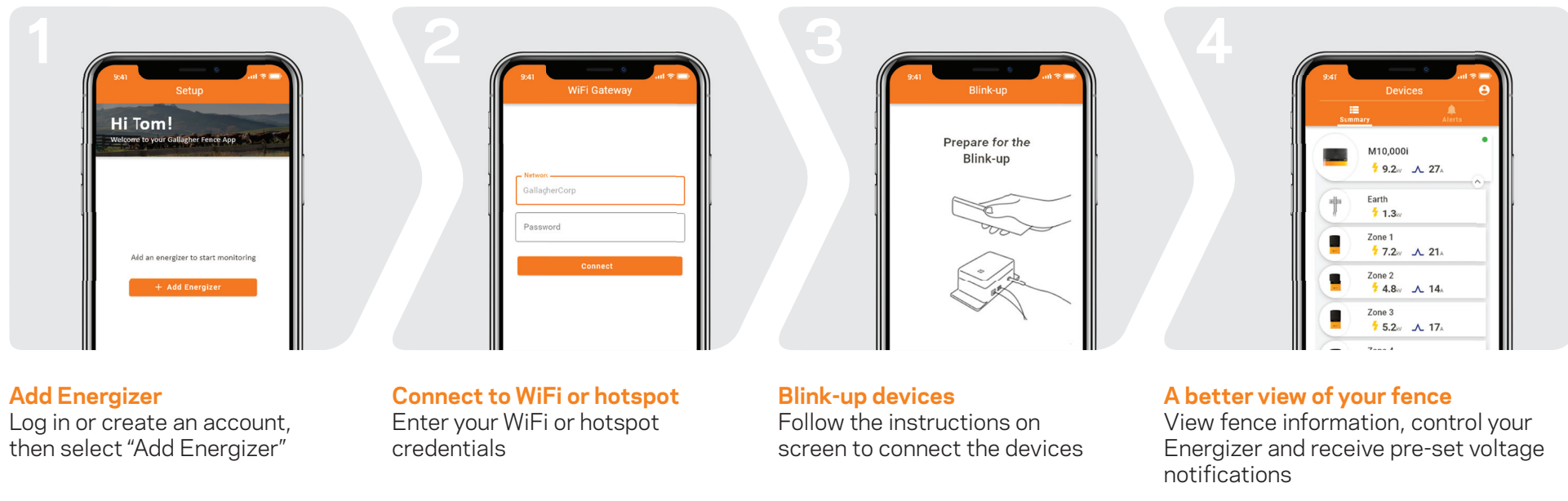

**Note:** This equipment has been tested and found to comply with the limits for a Class A digital device, pursuant to part 15 of the FCC Rules. These limits are designed to provide reasonable protection against harmful interference when the equipment is operated in a commercial environment. This equipment generates, uses and can radiate radio frequency energy and, if not installed and used in accordance with the instruction manual, may cause harmful interference to radio communications. Operation of this equipment in a residential area is likely to cause harmful interference in which case the user will be required to correct the interference at his own expense.

[www.gallagher.com](http://www.gallagher.com)

Gallagher Private Bag 3026, Hamilton, New Zealand

08/20 v5